

Austin's living room

City of Austin,
Austin Central Library
Austin, TX

Located in downtown Austin, the New Central Library reflects the eclecticism, authenticity, and diversity of Austinites and their way of life.



A Lake | Flato - Shepley Bulfinch joint venture, the New Central Library pays homage to two big ideas: Austin's love affair with books and with nature. Located next to Shoal Creek, the 198,000-sf building utilizes native, sustainable, and touchable materials, chosen to celebrate Austin's design and construction heritage.





Readers can sink into seats that wrap the sunlit perimeter, or take in views of hiking trails and Lady Bird Lake from screened outdoor reading porches. The Library also features display and demonstration areas, community meeting rooms of varying sizes, and a 350-seat event forum for presentations and performances.

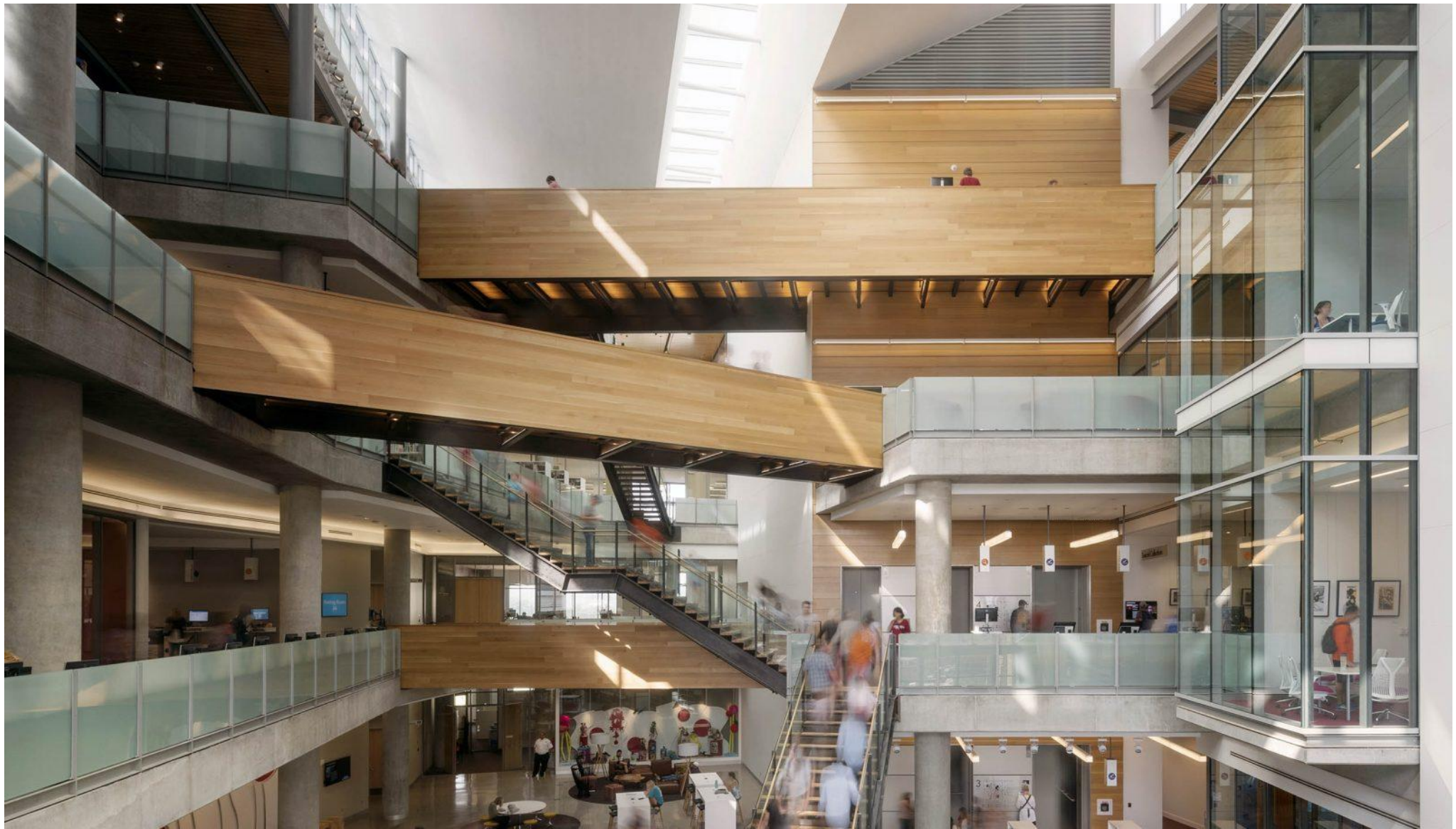



The space is defined by intersecting bridges and stairs that encourage serendipitous connections. Natural light floods the six-story atrium. An angled roof diffuses the unrelenting Texas sun.





The Library celebrates Austin's walking and biking culture with generous sheltered pedestrian walkways and connections to nearby hiking and biking trails.





Embracing Austin's commitment to the environment, rainwater harvesting, an in-ground cistern, and the building's vegetated roof work together to reduce water usage.



A photovoltaic cell generates 13% of the building's power and shades the rooftop garden. The Library uses 40% less energy than a building of comparable size.

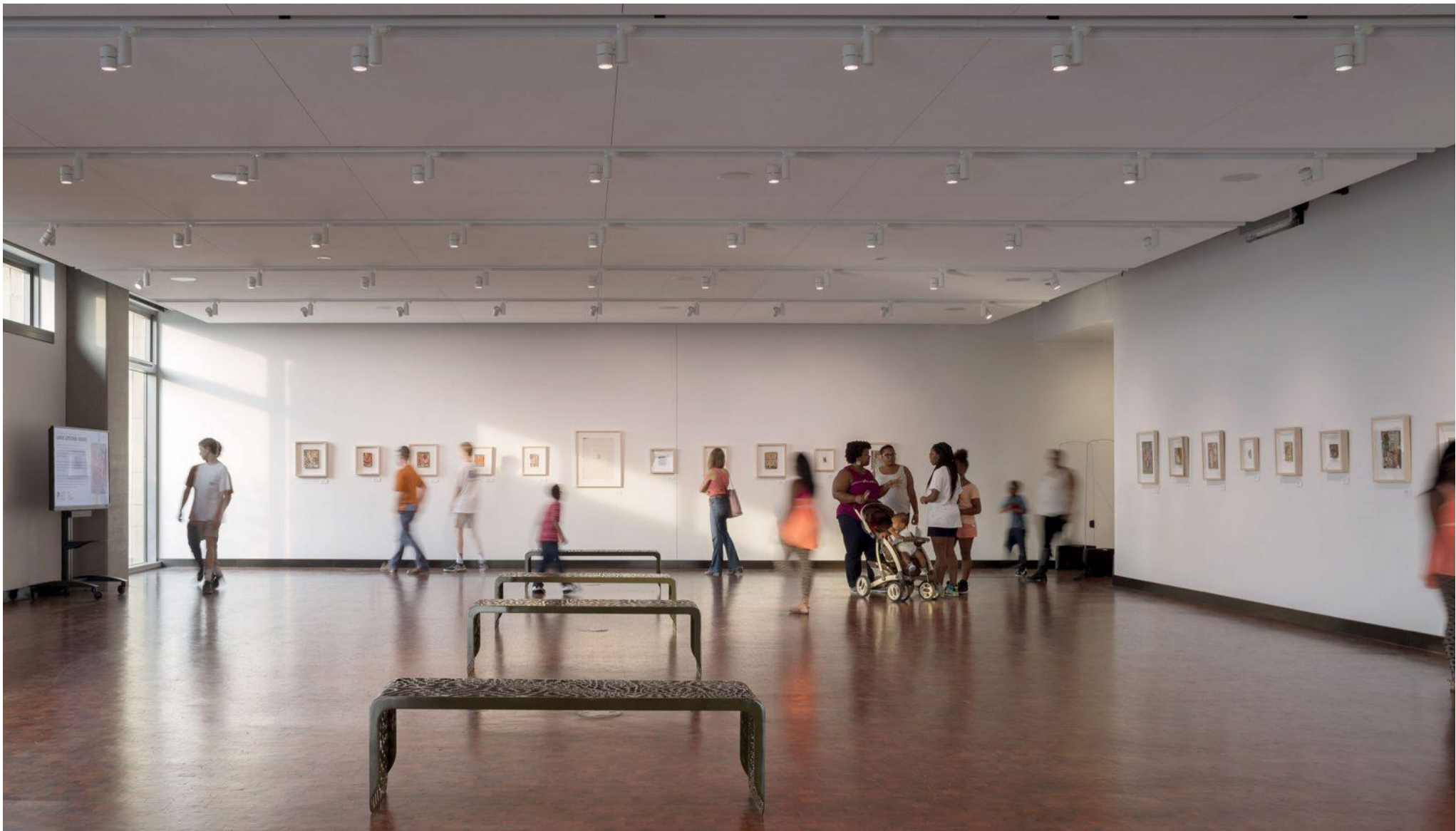

AIA/ALA

Library Building Award

ALA/IIDA

Library Interior Design Award

AIA Austin

Design Award

APWA Texas Chapter

Project of the Year

International Federation of
Library Associations and
Institutions

Public Library of the Year Nominee

Related projects



Jewel of the campus

Smith College

Reinventing an icon

Princeton University

A haven for the digital age

University of Notre Dame

(<https://shepleybulfinch.com/projects/smith-college-library-master-plan/>).
 (<https://shepleybulfinch.com/projects/princeton-university-firestone-library/>).
 (<https://shepleybulfinch.com/projects/university-of-notre-dame-hesburgh-libraries-master-plan-and-renc>

Design beyond what's expected.

Boston

99 Chauncy Street

4th Floor

Boston, MA 02111

617 423 1700

(tel:617-423-1700)

Hartford

100 Allyn Street

Floor 4

Hartford, CT 06103

860 422 4243

(tel:860-422-4243)

Houston

55 Waugh Drive

Suite 450

Houston, TX 77007

346 708 7042

(tel:346-708-7042)

Phoenix

3443 North Central

Ave

Phoenix, AZ 85012

602 430 3223

(tel:602-430-3223)

